

PRODUCT OVERVIEW

Manual Rotary Tables RH-RH1

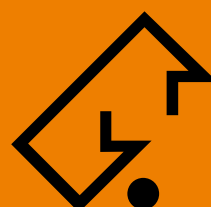

WERKZEUGSYSTEME
MÜLLER GMBH
HOFMANN
MESS- UND TEILTECHNIK

Precision made in Germany

Technical Data of HOFMANN Rotary Tables R2H-R2H1

Main characteristics

- Manual precision rotary table with compact and space saving design. The high rigidity allows the use for machine tools as well as for measuring applications.
- Table plate with 200 mm diameter and 360° graduation scale on the table plate circumference with zero point mark on the housing.
- Due to the low height and the light weight, the rotary tables are especially suitable for engraving and milling work.
- Manually operated worm gearing with eccentric worm shaft bearing for backlash adjustment or easy disengaging for rapid indexing.
- Relief of worm gear by two mechanical down hold clamps running in a notch on circumference of the table plate.

Versions

- **R2H** Rotary table with graduating drum and vernier scale for indirect indexing.
- **R2H1** Rotary table with dividing plate indexing device for indirect indexing of all divisions up to 50.

Accessories

- Manual three-jaw chuck with intermediate flange to be attached to the table plate.
- Hand wheel with micrometer dial and indexing plate device are interchangeable.
- Additional direct indexing plate for the indexing plate device for all divisions up to 100 and higher ones, many up to 400, with included adjusting table.



Accuracies

Size		20
Worm gear ratio	(i)	90:1
Indexing accuracy, indirect division	(sec)	± 30
Concentricity of the dividing spindle in the centre bore	(mm)	0.01
Axial runout of table plate	(mm)	0.01
Evenness of table plate	(mm)	0.01
Parallelism of the table plate to base area	(mm)	0.02
Weight	(kg)	19



Dimensions

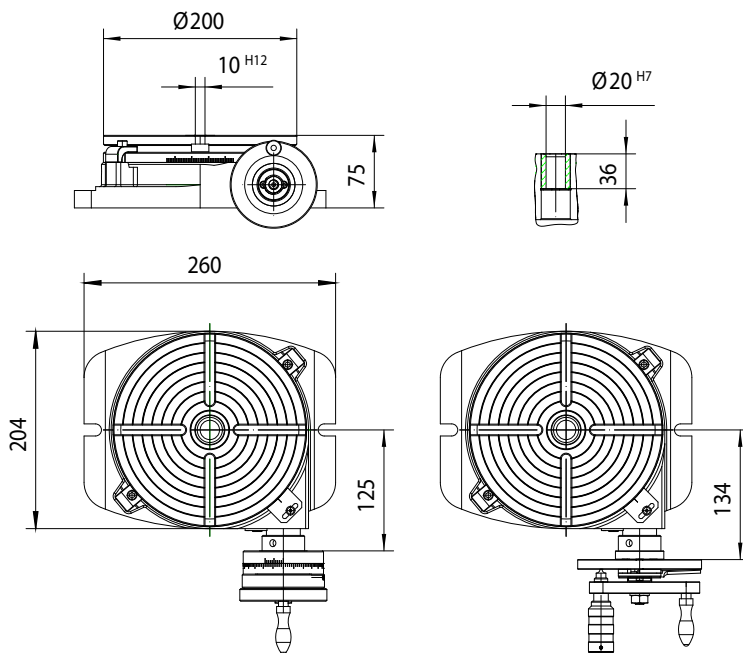

Load and performance data

Size		20
Load capacity for vertical axis max.	(kg)	80
Axial force max.	(kN)	15
Radial force max.	(kN)	5
Tilting moment indexing spindle clamped	(Nm)	300
Tangential moment with clamping	(Nm)	300



Precision Rotary Table **RH-20**



Precision Rotary Table **RH-20**



Manual three-jaw chuck



Hofmann Mess- und Teiltechnik is part of the renowned Müller group, a successful alliance of five companies, which offers great synergistic effects to their customers.

Having more than 80 years of experience combined with fresh creativity and innovational strength, Hofmann is a well sought-after partner by renowned manufacturers of machine tools for processing metal. Our efficient and customized solutions are produced by qualified specialists in our state-of-the-art machine shop in Pliezhausen near Stuttgart. Fast, cost-saving and specially designed for the needs of our customers.

**Invest in the technology of the brand name HOFMANN.
You will benefit from it!**



**WERKZEUGSYSTEME
MÜLLER GMBH
HOFMANN
MESS- UND TEILTECHNIK**

**Werkzeugeysteme Müller GmbH
Hofmann Mess- und Teiltechnik**

Robert-Bosch-Straße 5 | 72124 Pliezhausen
Phone: +49 7127/973-130 | Fax: +49 7127/973-015
Email: info@hofmann-mt.de | www.hofmann-mt.de